

# Dimension Tables

Dimensions of flanged motors according to DIN EN 50347

Type: B 5 (V1, V3)

Dimensions in mm

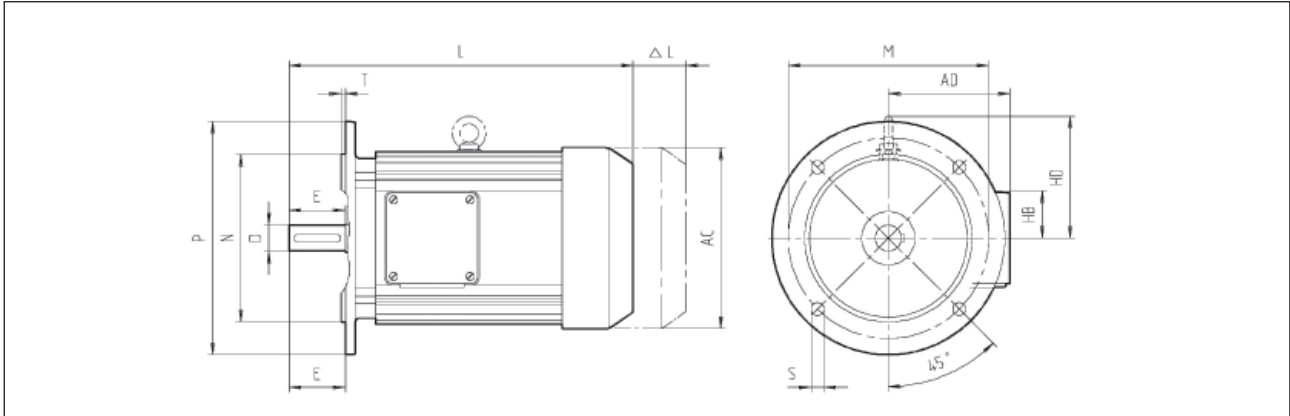

Model size	AC	AD	AD'	D	E	HB	HB'	HD	L	M	N	P	S	T	Brake Type	Δ L
56	110	90	106	9	20	40	47.5	-	188	100	80	120	7	3	EFB	35
63	124	96	112	11	23	40	47.5	-	209.5	115	95	140	9,5	3	EFB	32.5
71	139	101	117	14	30	40	47.5	-	237	130	110	160	9,5	3.5	EFB	40
															ZFB	54.5
80	158	108	124	19	40	40	47.5	-	273	165	130	200	11,5	3.5	EFB	40
															ZFB	67.5
90S	177	122	140	24	50	51	57.5	-	299.5	165	130	200	11,5	3.5	EFB	56.5
															ZFB	77
90L	177	122	140	24	50	51	57.5	-	324.5	165	130	200	11,5	3.5	EFB	56.5
															ZFB	77
100L	196	130	148	28	60	51	57.5	133	369	215	180	250	14	4	EFB	56.5
															ZFB	96
112M	220	140	158	28	60	51	57.5	142	389	215	180	250	14	4	ZFB	86.5
112Me	220	140	158	28	60	51	57.5	142	458	215	180	250	14	4	ZFB	86.5
132S	262	181	190	38	80	73	84	176	456	265	230	300	14	4	ZFB	109
132M	262	181	190	38	80	73	84	176	494	265	230	300	14	4	ZFB	109
132Md	262	181	190	38	80	73	84	176	524	265	230	300	14	4	ZFB	109
132L	262	181	190	38	80	73	84	176	564	265	230	300	14	4	ZFB	109
160M	310	-	238	42	110	-	84	204	587	300	250	350	18	5	ZFB	124
160L	310	-	238	42	110	-	84	204	631	300	250	350	18	5	ZFB	124

Illustrations are for reference only and subject to change.

The dimensional tables are for the following motor types:

- Three-phase AC Motors
- Single-phase motors without capacitor(s)
- Two-speed motors

Dimensions AD and HB apply to plastic junction box. Dimensions AD' and HB' apply to the aluminum junction box. Key way dimensions according DIN 6885 sheet 1.